

1st Floor

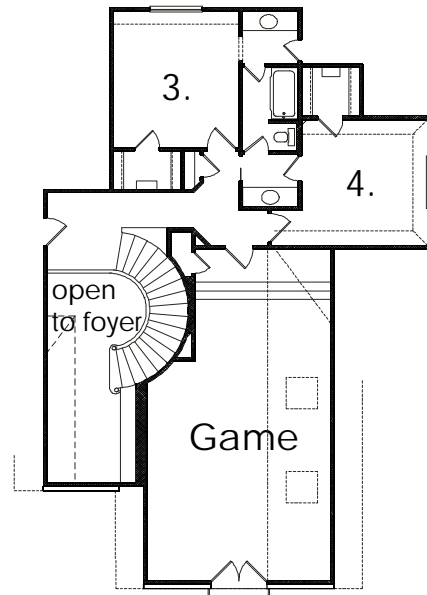

2nd Floor

The Calm Meadow

A courtyard with a fountain greets you as you approach the front door that leads you to a spacious foyer with a graceful circular stair. The family area has windows all along the back that open to the large covered patio. This home also has a unique 3 car garage arrangement and a huge game room.

Specifications

1st floor	2,476
2nd floor	1,200
Total Living Area	3,676 Sq. Ft.
4 Bedrooms, 3 Baths, 3 Living Areas	
59'-8" Wide x 83'-2" Deep	
<i>1st Floor</i>	
Study 13' x 13'	
Family Room 22'-4" x 17'	
Dining Room 13' x 11'	
Master Bedroom 14'-8" x 17'	
Kitchen 17'-2" x 13'	
Breakfast 14'-6" x 11'	
Bedroom #2 12' x 11'-10"	
<i>2nd Floor</i>	
Bedroom #3 12' x 13'	
Bedroom #4 12' x 12'	
Game Room 17'-6" x 31'-8"	



Floor plans & elevations are subject to change and dimensions are approximate. Purchasers are advised consult their state and local building authorities and a state certified architect prior to any construction related to these plans.
© Copyright 1998